

Clark B. McDonald - President
Billy Minish – Executive Vice President
Haley Hampton - Secretary/Treasurer



1955 Highway 129 South
P.O. Box 960
Cleveland, GA 30528
(706) 865-3155 Phone
(706) 865-7032 Fax

CONSTRUCTION MANAGER'S CLARIFICATION NUMBER ONE (1)

DATE: MARCH 15, 2019

TO: PROSPECTIVE BIDDERS

FROM: CJ MCDONALD, PROJECT MANAGER

RE: LUMPKIN COUNTY LIBRARY

PLEASE NOTE

ITEM # 1 – BP #6 ROUGH AND FINISH CARPENTRY/ROOFING

For clarification, please note:

-No Bid Bond or Payment and Performance Bond required for this bid package.

ITEM # 2 – BP #6 ROUGH AND FINISH CARPENTRY/ROOFING

For clarification, please note:

-Window sills are to be included as trim work in this bid package.

ITEM # 3 - BP # 1 SITEWORK

For clarification, please note:

- Please see the attached Rainwater Piping that is to be included in this bid package.

ITEM # 4 – BP # 1 SITEWORK

For clarification, please note:

- Please see the attached Paving detail. This will be the paving specifications used in this bid package.

Base and binder to be installed at the Construction Manger's direction prior to building construction.

ITEM #5-

For clarification, please note:

-Import fill dirt shall be suitable for structural fill, pavement fill or general area fill based upon the area in which it is placed. A third party testing consultant will confirm if import dirt is suitable.

ATLERNATE # 1

Please Note:

-Sheet C-002-01 is the **base bid** grading plan and Sheet C-002-02 is the alternate grading plan.

Please list Alternate #1 cost on the bid form in your front end documents. This alternate, at a minimum impacts bid packages #1-Sitework, #2-Landscaping, #3- Concrete, #4-Masonry. For Concrete, the concrete retaining wall and sidewalk will be an added scope. For Masonry, the brick on the retaining wall will be an added scope. For landscaping, the planting, sod and irrigation area directly behind the retaining wall as shown on sheet L1.1 is added scope

**** End of Construction Manager's Clarification ****

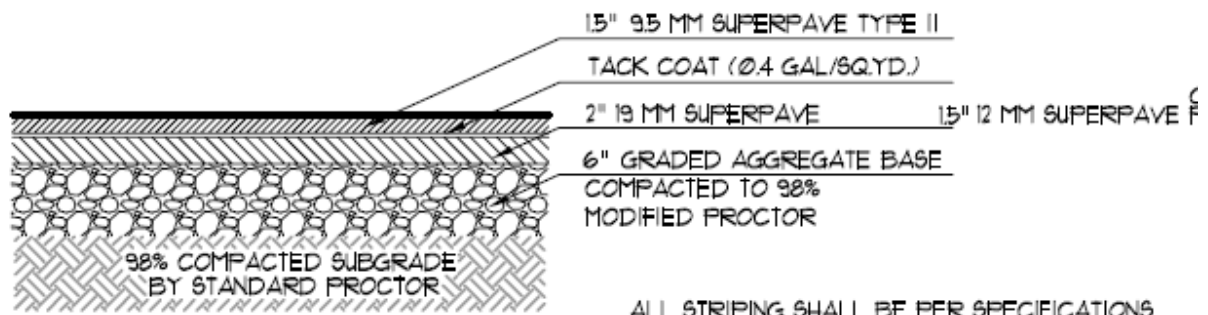

ALL STRIPING SHALL BE PER SPECIFICATIONS

MEDIUM DUTY ASPHALT PAVING

NOT TO SCALE

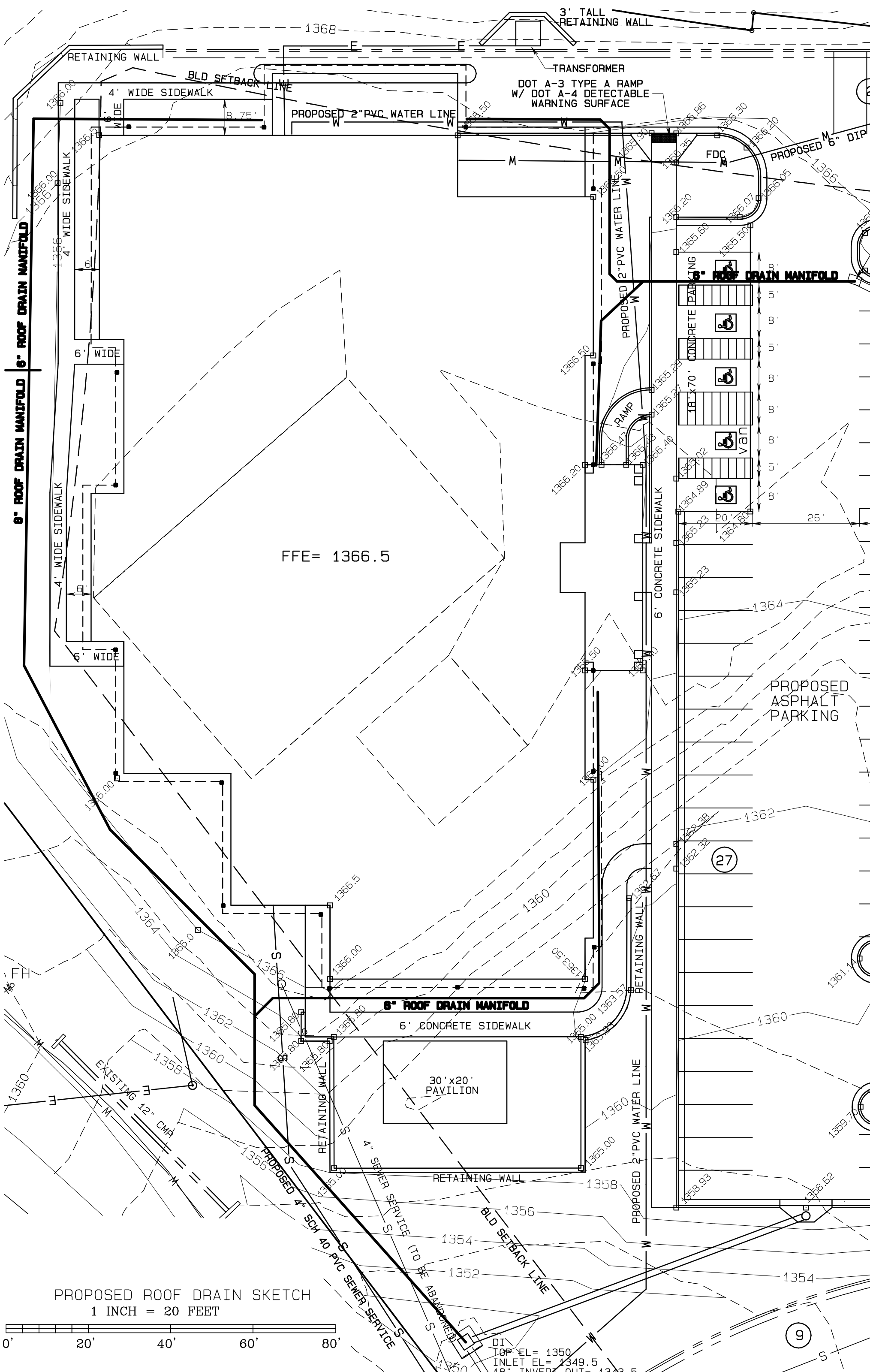

FFE= 1366.5

PROPOSED ROOF DRAIN SKETCH
1 INCH = 20 FEET

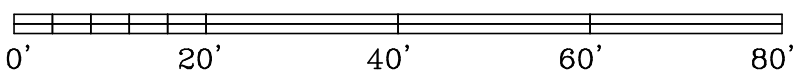

DI
TOP EL= 1350
INLET EL= 1349.5
18" INVERT OUT= 1343.5

9

27

2